

1	2	3	4	5	6
Item No.	DESCRIPTION	QTY.	MATERIAL	Wt. kg TOTAL	REMARKS

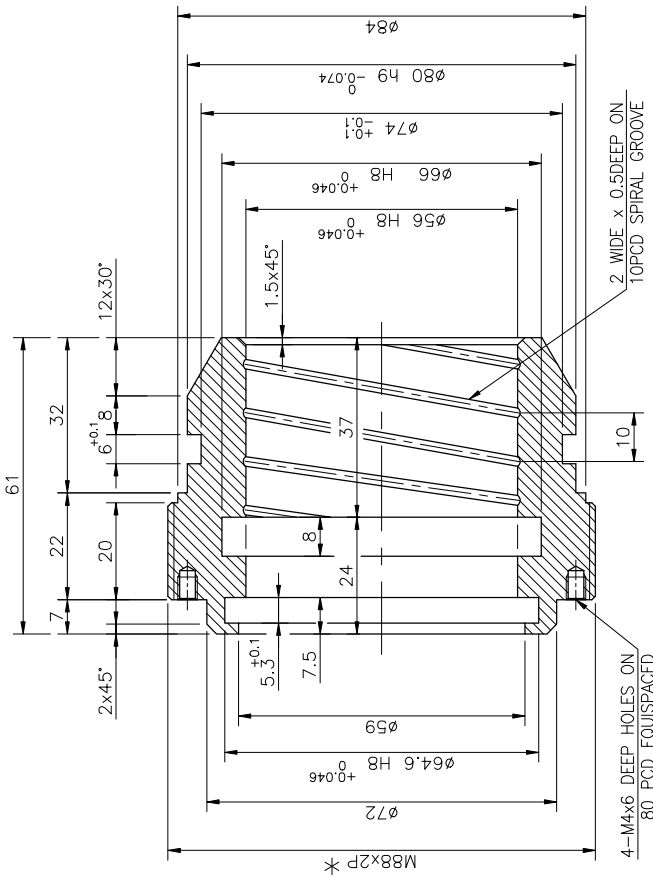

SECTION S1S1

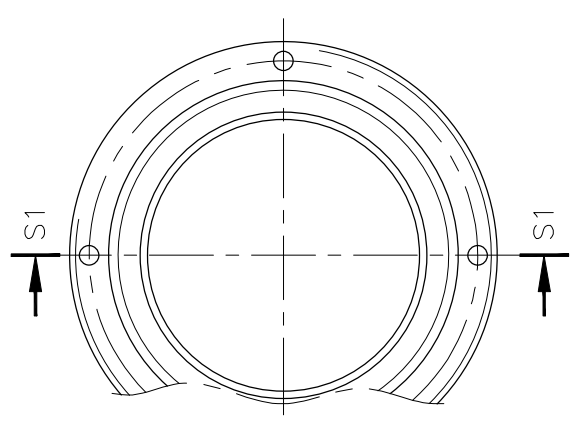

NOTES:-
 1) MATERIAL : ASTM B30 Grade C95500
 2) WEIGHT : 1.2 KG.
 3) DIMENSION MARKED * LIKE THIS TO BE MATCHED WITH ROD GUIDE FLANGE.

Mohammed Shaikh
 C=QA, OU=Engineering
 Cad Lab, O=Qatar Steel
 Co., CN=Mohammed
 Shaikh,
 E=mohammedshaikh@qa
 tarsteel.com.qa
 Engineering Cad Lab
 2022.11.21 07:55:
 12+03'00'



REV	DATE	DESCRIPTION	DRN	CHD	APP
REVISIONS					
ITEM CODE	ASSET NO.	AREA / EQUIP. No.			
	501HYDS069-001	QSC/SMS/EFCC-5/EAF			
QATAR STEEL COMPANY					
TOLERANCES UNLESS SPECIFIED OTHERWISE		DO NOT SCALE			
ANGULAR DIMS	LINEAR DIMENSIONS	NAME		DATE	
OVER	UP TO	DRAWN		15/11/22	
0-6	6-30	CHECKED		15/11/22	
±0.1	±0.2	APPROVED		15/11/22	
±0.5	±1.0	SCALE :		SUPPLIER DRG. No.	
±1.0	±1.0	1:1		-	
GENERAL NOTES					
ALL DIMENSIONS ARE IN MM UNLESS SPECIFIED OTHERWISE. UNMACHINED FACES TO BE \sqrt{R} OR BETTER, UNLESS SPECIFIED OTHERWISE.					
ALL SHARP EDGES TO BE CHAMFERED TO 0.6x45°(MAX).					
ALL SHARP CORNERS SHALL HAVE RADIUS 0.4 (MAX).					
REMOVE BURRS FROM ALL FEATURES. ALL CUT EDGES SHALL HAVE SURFACE FINISH \sqrt{R} OR BETTER. MACHINE ALL OVER.					
THIS DWG. IS THE PROPERTY OF QATAR STEEL. IT IS TO BE USED ONLY FOR THE PROJECT AND IN THE MANNER OR DESIGN OR SPECIFICATION OF QATAR STEEL. PARTS MANUFACTURED THEREOF WITHOUT WRITTEN PERMISSION OF QATAR STEEL.					
Q No.	3-12013	SHT No.	1	OF	1
SIZE	A3				
DRG. No.	129-MHEA-504-01-B5				
REV.	0				

REQUEST No.	4164391	No.	3	REFERENCE DWG. No.	
REV	4				